

SUBMERSIBLE STAINLESS STEEL PUMP **SQ2**

Newly designed SQ Series pumps, now **lighter and easier to carry!**



50SQ2-2.4S 50SQ2-2.75

- It is made of 304/316 stainless steel, Nitrile Butadiene Rubber and special resin to stand up to rust and corrosion, and sport a new structural design that makes them even lighter and easier to carry
- Non-toxic white mineral oil used to lubricate mechanical seals allows for use in food / agriculture industries
- The flow-through design and heat resistant silicon carbide mechanical seals Built-in motor protector
- Designed to fit into an 8-inch pipe

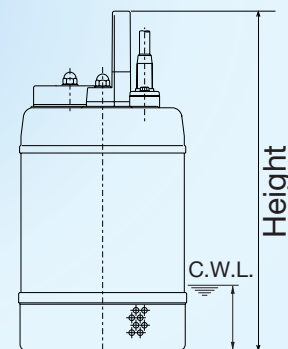
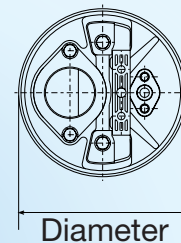
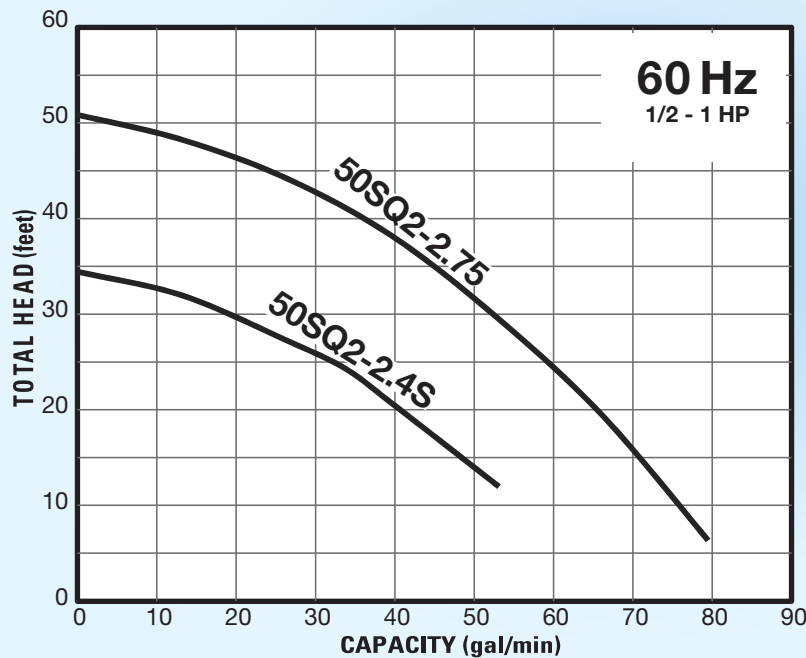

MODEL	MOTOR SPECIFICATIONS								Discharge Size (inch)	DIMENSION		Max. Solids Dia. (inch)	Continuous Running Water Level C.W.L. (in.)	Pump Weight (lbs.)	
	Motor Output (HP)	Phase	Rated Current (A)							RPM	Diameter (in.)				Height (in.)
			Single phase		Three phase										
115V	230V	208V	230V	460V	575V										
50SQ2-2.4S	1/2	Single	5.1	2.9	—	—	—	—	3361	2	7 1/16	14 7/16	0.236	2 3/8	23
50SQ2-2.75	1	Three	—	—	3.4	3.5	2.0	1.5	3320	2	7 1/16	15 3/16	0.236	2 3/8	26