

C SERIES | Tsurumi C Series CUTTER PUMP™

Tsurumi C Series Cutter Pump™ is solids handling non-clog submersible pump with a unique tungsten carbide tipped single or multi-vane impeller and high chrome serrated wear plate for shredding of solids. Municipal, industrial and commercial applications. 1HP to 30HP, Single phase and three phase available.

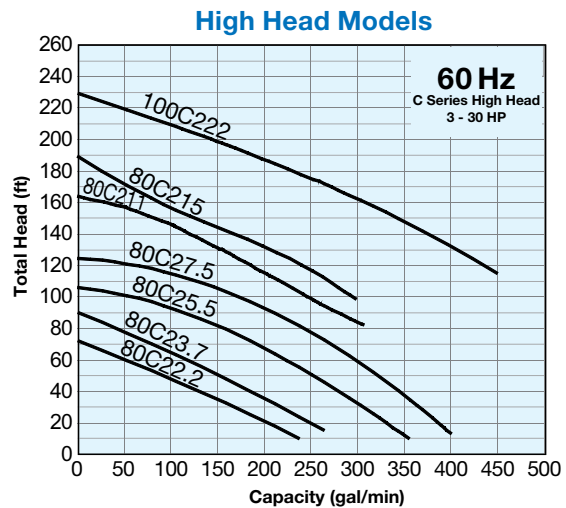
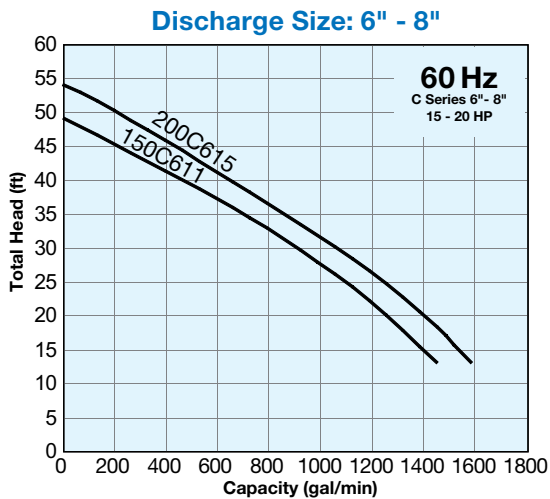
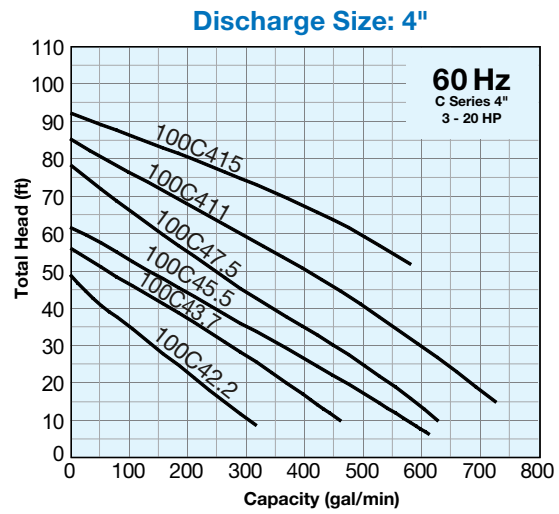
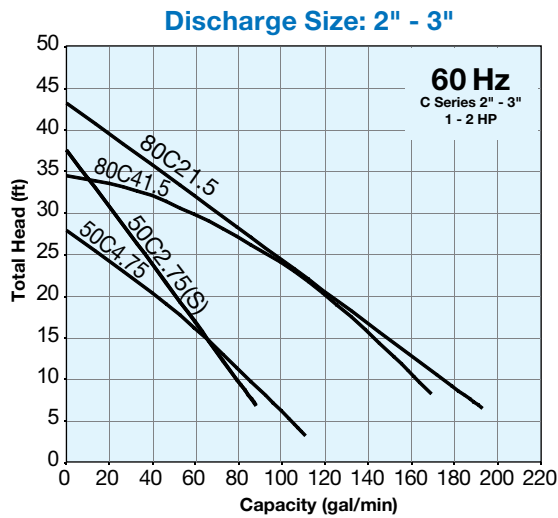

Applications

- Municipal wet well lift stations
- Municipal dry pit stations
- Retail stores / restaurants
- Sewer bypass
- Nursing homes / housing developments
- Prisons
- Hospitals
- Pulp and paper mills
- Industrial processing
- Oil refining
- Food processing
- Farming
- Campgrounds
- Hotels

Optional Discharge with 3" & 4" Discharge Size

Reduced overall width allows pump to be used in confined areas, including sewer bypass applications. Please contact factory for specific dimensions. (Also compatible with other models)



Dimension: Free Standing A / B / C

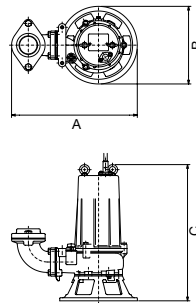

Dimension: Guide Rail Fitting (TO / TOS) D / E / F

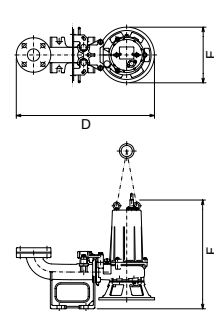

Single Phase Model	Motor Output (HP)	Rated Current (A)				*S.S. (RPM)	Discharge Size (in.)	Dimensions (in.)						Max. Solids Dia. (in.)
		115V		230V				Free Standing Models			TOS Guide Rail Models			
		A	B	C	D			E	F					
50C2.75S*	1	11.7	5.9			3600	2	15 15/16	9 13/16	20 9/16	24 7/16	9 13/16	22 5/16	0.827

Three Phase Model	Motor Output (HP)	Rated Current (A)				*S.S. (RPM)	Discharge Size (in.)	Dimensions (in.)						Max. Solids Dia. (in.)
		208V	230V	460V	575V			Free Standing Models			TOS Guide Rail Models			
		A	B	C	D			E	F					
50C2.75*	1	3.5	3.5	1.8	1.4	3600	2	15 15/16	9 13/16	16 5/16	24 7/16	9 13/16	18 1/16	0.827
50C4.75	1	3.5	3.6	1.8	1.5	3600	2	16 13/16	11 3/16	19 5/8	25 5/16	11 3/16	21 9/16	1.02
80C21.5*	2	6.2	5.9	3.1	2.3	3600	3	17 9/16	9 13/16	21 1/8	26 5/8	9 13/16	23 1/16	1.18
80C41.5	2	6.6	6.4	3.2	2.6	1800	3	19 5/8	12 7/16	22 5/8	28 11/16	12 7/16	23 7/8	1.26
100C42.2	3	9.4	8.5	4.3	3.5	1800	4 or 3	24 3/16	12 3/4	24 1/4	30 1/16	12 3/4	24 13/16	1.73
100C43.7	5	15.0	13.8	6.9	5.4	1800	4 or 3	24 3/8	13 1/8	27 3/16	30 1/4	13 1/8	27 9/16	2.17
100C45.5	7.5	22.2	20.8	10.4	8.3	1800	4	27 13/16	16 1/8	35 3/4	36	15 1/8	35 11/16	1.57
100C47.5	10	29.8	28.0	14.0	11.5	1800	4	27 13/16	16 1/8	36 9/16	36	15 1/8	36 1/2	1.57
100C411	15	41.4	38.0	19.0	14.7	1800	4	28 11/16	17 3/16	39 3/8	36 15/16	16 15/16	39 5/16	1.97
100C415	20	55.8	51.6	25.8	20.6	1800	4	28 5/8	17 3/16	42 1/2	36 7/8	16 11/16	42 7/16	1.57
150C611	15	43	40	20	16	1200	6	41 1/16	23 11/16	47 11/16	48 3/8	22	46 5/16	3.62
200C615	20	58	52	26	21	1200	8	43 1/4	23 11/16	49 5/8	56 1/4	22	49 1/16	3.62

* Not for use in commercial applications (Residential sewage only)

Three Phase Model: High Head	Motor Output (HP)	Rated Current (A)				*S.S. (RPM)	Discharge Size (in.)	Dimensions (in.)						Max. Solids Dia. (in.)
		208V	230V	460V	575V			Free Standing Models			TOS Guide Rail Models			
		A	B	C	D			E	F					
80C22.2	3	10.0	9.8	4.9	3.8	3600	3	21 1/8	10 1/4	24 1/16	27 5/16	10 1/4	25 3/16	0.787
80C23.7	5	14.4	13.6	6.8	5.3	3600	3	21 1/8	10 1/4	24 1/16	27 5/16	10 1/4	25 3/16	0.866
80C25.5	7.5	22.3	21.4	10.7	8.3	3600	3	24 15/16	13 9/16	34 5/8	31	12 5/8	34 1/2	0.906
80C27.5	10	26.9	25.6	12.8	10.2	3600	3	24 15/16	13 9/16	34 5/8	31	12 5/8	34 1/2	0.906
80C211	15	40.8	39.2	19.6	15.4	3600	3	24 15/16	13 9/16	36 1/2	31	12 5/8	36 7/16	0.984
80C215	20	54	50	25	20.0	3600	3	28 3/4	16 15/16	42 3/4	36 7/8	16 15/16	42 3/4	1.02
100C222	30	---	---	35	28	3600	4	33 3/4	20 1/16	46 5/8	40 3/8	20 1/16	46 5/8	1.02

* S.S. = Synchronous Speed