



TSURUMI PUMP

**FSP - SERIES
SCUM SKIMMER PUMP**

SECTIONAL VIEW

8-FSPS

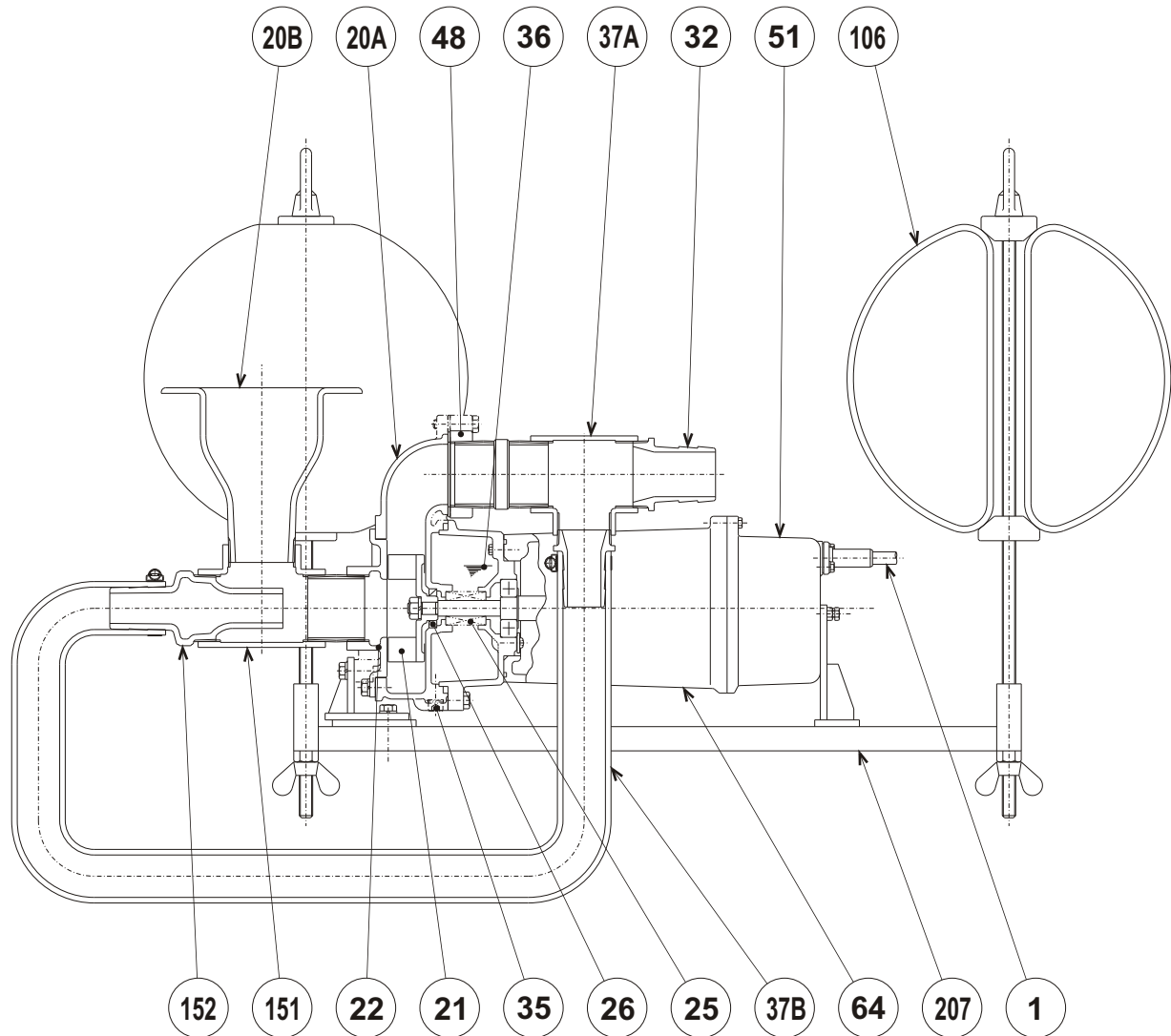

PART#	DESCRIPTION	MAIN MATERIAL / NOTE	ASTM, AISI CODE	RELATED DIN CODE	QTY
1	Power Cable	PVC Sheath AWG14/3- 32ft			1
20A	Pump Casing	Cast Iron	A48M Class30B	EN 1561 GJL-200	1
20B	Suction Opening	Resin	A48M Class30B	EN 1561 GJL-200	1
21	Impeller	Cast Iron	A48M Class30B	EN 1561 GJL-200	1
22	Suction Cover	Cast Iron	A48M Class30B	EN 1561 GJL-200	1
25	Mechanical Seal	Silicon Carbide / W-14HC			1
26	Oil Seal	NBR / SC-22357			1
32	Hose Cupling	Resin			1
35	Oil Plug	Stainless Steel	S 30400	1.4301	1
36	Lubricant	Turbine Oil ISO VG32 or SAE 10W-20			
37A	Discharge Pipe	Cast Iron	A48M Class30B	EN 1561 GJL-200	1
37B	Circulating Hose	Vinyl Suction Hose			1
48	Companion Flange	Resin			1
51	Head Cover	Cast Iron	A48M Class25B	EN 1561 GJL-150	1
64	Motor Housing	Cast Iron	A48M Class25B	EN 1561 GJL-150	1
106	Float	Resin			3
151	Suction Casing	Cast Iron	A48M Class30B	EN 1561 GJL-200	1
152	Nozzle	Resin			1
207	Frame	Steel Pipe (& Steel)	A53 Type F (& A283 Grade D)	DIN 1615 St 33 (& EN 10025 S275)	1