

Parts List	Wastewater Pumps	Control No: PN-1-1-1	Date: 03-18-2005
------------	------------------	----------------------	------------------

ITEM	PARTS No.	DESCRIPTION	Q'TY	SIZE	MATERIAL	PRICE (\$)	NOTES
1	001-943-23	Power Cable 32'-110V	1	TLB, AWG16/3 x 32', 316-Gland (w/ CSA3P)	VCT	66.00	001-466-14(OLD)
1	001-952-12	Power Cable 32'-220V	1	TLB, AWG16/3 x 32', 316-Gland	VCT	93.10	see 001-466-14/-943-23 w/o Plug
1	001-471-25	Power Cable 50'-110V-Option	1	LB, AWG14/3 x 50' (w/ CSA3P)	VCT	147.50	
2	143-146-18	Tapping Screw	2	M5x20 (Pan), w/ Washer, Sprit	SUS304	0.50	
3	003-100-13	Gland	1	LB	SUS304	5.50	c/w Power Cable
4	051-224-13	Motor Head Cover	1	3/4/8-PU(T)	Resin	77.00	
5	141-029-18	Acorn Nut	4	M6	SUS304	2.10	
6	142-126-19	Washer	4	M6	SUS304	0.20	
7	127-200-11	Retainer (Capacitor)	1	3/4/8-PU(A/W)	SECC	3.60	
8	143-153-18	Tapping Screw	2	M3.5x8 (Truss)	SWCH	0.30	
9	076-136-14	Capacitor 110/115/120V-60HZ	1	SH-JPX , 43MFD-220VAC		65.10	
9	076-137-15	Capacitor 220V-60HZ	1	SH-JPX , 12MFD-450VAC		71.60	
10	053-428-15	Motor Protector 110/115/120V-60HZ	1	KA142-BPVL10 (T+H)		20.60	
10	053-450-16	Motor Protector 220V-60HZ	1	KA142-LPVL01 (T)		20.60	
11	143-138-17	Tapping Screw	2	M4x12 (Truss)	SWRM	0.40	
12	143-148-10	Pan Screw	4	M5x145 (20L)	SWRM	2.70	
13	142-112-25	Washer	4	M5 (N, D=10)	SPC	0.40	see 142-112-12
14	121-472-18	Gasket (H.Cover/H.C.Spacer)	1	P.C.125xd130x2.3t	NR	6.10	*
15	082-102-10	Head Cover Spacer	1	3/4/8-PU(A/W)(T)	Resin	49.70	
16	121-471-17	Gasket (H.C.Spacer/M.Frame)	1	d126.6xD135.6x6t	NR	5.00	*
17	050-411-16	Motor Bracket	1	3/4/8-PU(A/W)(T)	SPC	23.10	
18	009-187-12	Grounding Wire	1	AWG16 x 150L		3.30	
18	009-190-18	Grounding Wire	1	AWG16 x 150L , G/Y		1.60	
19	143-085-34	Pan Screw	1	M4x6, w/ S.Washer	BSBM	0.40	see 143-085-21
20	056-702-15	Stator 100V-50/60HZ	1	3-PU(A/W) (100-50/60)		319.70	c/w Motor Frame
20	056-745-10	Stator 220V-60HZ	1	3-PU(A/W) (220/230-50, 220-60)		383.60	c/w Motor Frame
20	056-746-11	Stator 230/240V-50HZ	1	3-PU(A/W) (230/240-50)		383.60	c/w Motor Frame
21	071-325-17	Collar	1	54L	SECC	2.40	
22	142-192-16	Wave Washer	1	#6201 (T=0.4)	SK-5	2.40	
23	052-100-15	Ball Bearing (Upper)	1	6201ZZC3		7.00	
24	055-689-12	Rotor and Shaft	1	3-PU(A/W)		159.80	c/w Ball Bearings
25	061-157-15	Bearing Collar	1	d15.1xD21x1.6t	SPC	3.80	
26	052-101-16	Ball Bearing (Lower)	1	6202ZZC3		8.90	
27	060-400-13	Bearing Housing	1	3/4-PU(T)	ADC	62.20	
28	025-290-19	Mechanical Seal	1	W-14HL	SiC+CCBN	51.10	
29	121-464-17	Gasket (M.Frame/O.Casing)	1	3/4/8-PU(T)	NBR	4.30	*
30	035-127-15	Oil Plug	1	M10x15 (Binding Screw)	SUS304	3.30	
31	121-246-11	Gasket (Oil Plug)	1	d10.3xD16x2t	PE-sheet	0.80	*
32	140-435-18	Bolt	4	M6x30, w/ Washer	SUS304	1.10	
33	029-300-15	Oil Casing	1	3/4/8-PU	Resin	46.20	
34	143-139-18	Truss Screw	4	M6x40, w/ PE-Washer	SUS304	1.40	
35	142-354-18	Conical Spring Washer	1	d11.2xD22.5x0.8t	SUS304	0.60	
36	021-G27-20	Impeller (60Hz)	1	3-PU/PN/TM-60Hz	Resin	11.10	60Hz
36	021-G26-29	Impeller (50Hz)	1	4-PU/PN/TM-60Hz	Resin	11.10	50Hz
37	143-140-12	Truss Screw	1	M6x12, w/ Washer	SUS304	0.90	
38	122-452-15	O-Ring (O.Casing/U.P.Casing)	1	130xD2.8	NBR	2.10	*
39	020-908-12	Upper Pump Casing	1	3/4/8-PU/PN/PSH, Upp.	Resin	48.00	
40	203-065-11	Ball (Air Valve)	1	d17	Glass	1.40	
41	121-465-21	Gasket (U./L. P.Casing)	1	3/4/8-PU(T) (Gray)	NBR	7.50	* NEW
41	121-465-18	Gasket (U./L. P.Casing)	1	3/4/8-PU(T)	NBR	7.50	* OLD
42	020-909-13	Lower Pump Casing	1	3/4/8-PN/PSH/TM, Low.	Resin	33.70	
43	023-445-15	Strainer Stand	1	3/4/8-PN/PSH/TM	Resin	14.20	
44	143-141-13	Pan Screw	6	M6x80, w/ Washer	SUS304	1.80	
45	140-436-19	Bolt	2	M8x55, w/ Washer	SUS304	1.20	
46	048-274-18	Companion Flange 2" NPT	1	NPT-2" (P.C.90)	Resin	26.20	
47	121-469-12	Gasket (Companion Flange)	1	P.C.90xD58x2t	NR	1.80	* for 50mm (2") Discharge
48	141-121-11	Nut	2	M8 (S=12)	SUS304	0.70	
<Gasket O-Ring Set>							
	173-500-17	Gasket O-Ring Set	1set	(*)		24.30	for 40mm (1 1/2") Discharge
	173-501-18	Gasket O-Ring Set	1set	(*)		24.30	for 50mm (2") Discharge
14	121-472-18	Gasket (H.Cover/H.C.Spacer)	1	P.C.125xd130x2.3t	NR	6.10	*
16	121-471-17	Gasket (H.C.Spacer/M.Frame)	1	d126.6xD135.6x6t	NR	5.00	*
29	121-464-17	Gasket (M.Frame/O.Casing)	1	3/4/8-PU(T)	NBR	4.30	*
31	121-246-11	Gasket (Oil Plug)	1	d10.3xD16x2t	PE-sheet	0.80	*
38	122-452-15	O-Ring (O.Casing/U.P.Casing)	1	130xD2.8	NBR	2.10	*
41	121-465-21	Gasket (U./L. P.Casing)	1	3/4/8-PU(T) (Gray)	NBR	7.50	* NEW
41	121-465-18	Gasket (U./L. P.Casing)	1	3/4/8-PU(T)	NBR	7.50	* OLD
47	121-468-11	Gasket (Companion Flange)	1	P.C.90xD45x2t	NR	1.80	* for 40mm (1 1/2") Discharge
47	121-469-12	Gasket (Companion Flange)	1	P.C.90xD58x2t	NR	1.80	* for 50mm (2") Discharge
		Lubricant		Turbine Oil#32 250 mL (8.5 floz)	(SAE 10W-20)		

\* Indicates items included in set

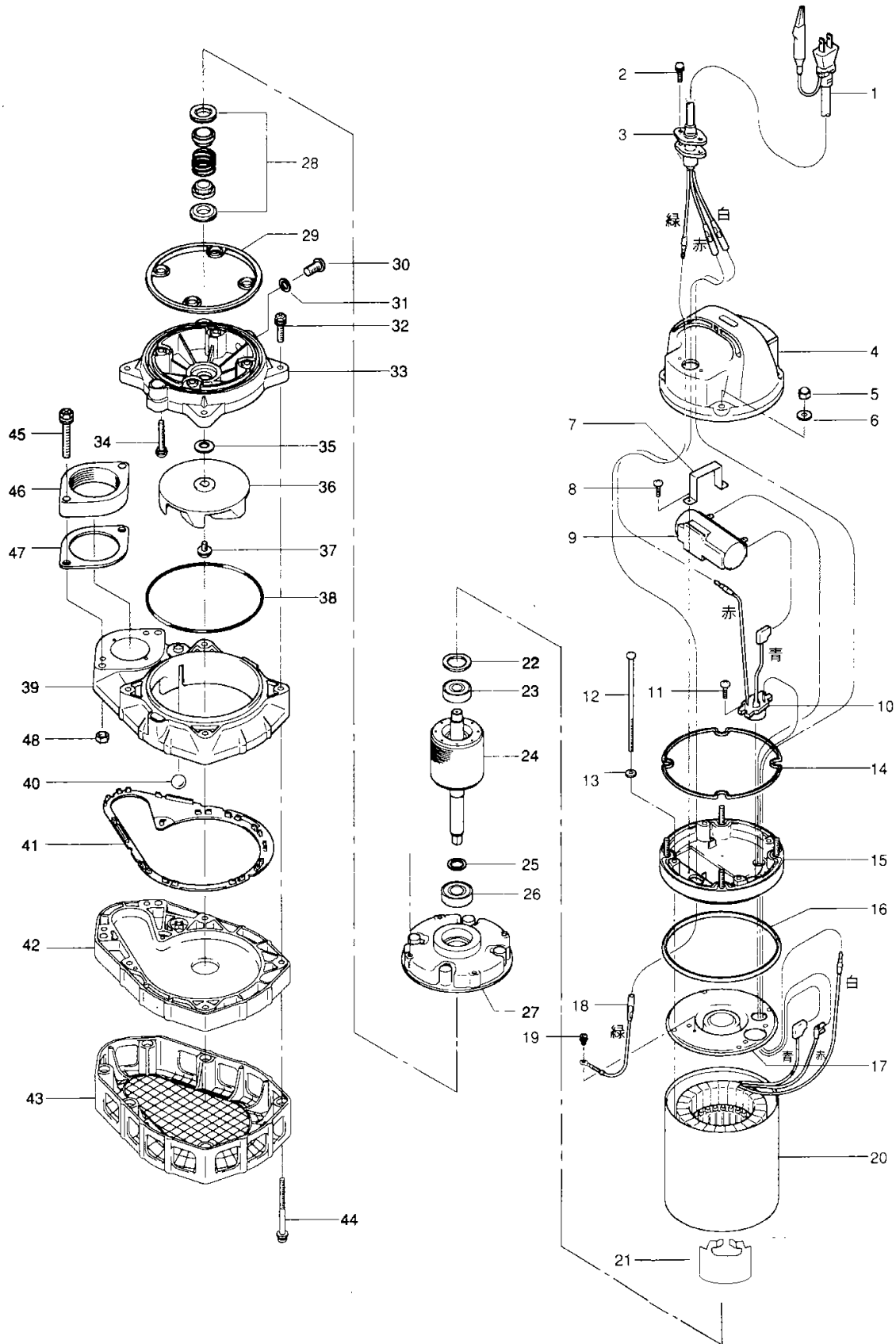



MODEL 50PN2.25S-61

Parts List		Wastewater Pumps		Control No: PN-1-1-1		Date: 03-18-2005	
ITEM	PARTS No.	DESCRIPTION	Q'TY	SIZE	MATERIAL	PRICE (\$)	NOTES
		Parts for guide rail fittings are shown in the following Control No.					
		TOK3-P (TOK3-3-1-1)					

Parts List

Wastewater Pumps

Control No: PN-1-1-1

Date: 03-18-2005

