

| PARTS LIST | | CONTRACTOR PUMP | | | 3/5/2013 | |
|------------|------------|-----------------------------------|-----|------------------------|----------|-------|
| ITEM | PART No. | DESCRIPTION | QTY | SIZE | MATERIAL | NOTES |
| 1 | 009-127-14 | Terminal | 4 | R-1.25-4 | CU | |
| 2 | 140-427-17 | Hex.Bolt (w/Plain Washer) | 2 | M5x15 | SUS304 | |
| 3 | 003-190-10 | Gland | 1 | | SUS316 | |
| 4 | 001-006-55 | Cabtyre Cable Set (8m) | 1 | VCT4Cx1.25mm2 | LBTmm2 | |
| 5 | 009-104-15 | Solderless Terminal | 4 | TMVB-1.25 | CU | |
| 6 | 009-117-11 | Terminal | 7 | R-22-6 | CU | |
| 7 | 001-535-15 | Cabtyre Cable (Sold per meter) | 8 | 2PNCT4Cx22mm2 | ((/m) | |
| 8 | 140-056-11 | Hex.Bolt | 8 | M8x30 | SUS304 | |
| 9 | 141-005-18 | Hex.Cap Nut | 8 | M8 | SUS304 | |
| 10 | 003-188-15 | Gland | 2 | BG3(30-4P) | FC | |
| 11 | 005-139-17 | Bush Washer | 2 | d33xd53.5x3t | SUS304 | |
| 12 | 004-111-23 | Cable Bush | 1 | No.6A | SBR | |
| 13 | 140-076-17 | Hex.Bolt | 8 | M10x30 | SUS304 | |
| 14 | 142-164-19 | Spring Washer | 8 | M10 | SUS304 | |
| 15 | 006-162-12 | Stuffing Box | 2 | BG3 | FC | |
| 16 | 001-533-13 | Cabtyre Cable (Sold per meter) | 8 | 2PNCT3Cx22mm2 | ((/m) | |
| 17 | 005-138-16 | Bush Washer | 2 | d29xd53.5x3t | SUS304 | |
| 18 | 004-110-19 | Cable Bush | 1 | No.6 | SBR | |
| 19 | 009-107-18 | Terminal | 6 | R-14-6 | CU | |
| 20 | 143-041-12 | Pan Screw | 7 | M6x8 | SWRM | |
| 21 | 141-004-59 | Hex.Nut | 7 | M6 | SWRM | |
| 22 | 009-117-11 | Terminal | 7 | R-22-6 | CU | |
| 23 | 002-115-18 | Heat Shrink Tube (Sold per meter) | m | EVA(d16.5x1t) | ((/m) | |
| 24 | 002-116-19 | Heat Shrink Tube (Sold per meter) | m | A4(d19x0.35t) | ((/m) | |
| 25 | 122-132-16 | O-Ring | 2 | G-105(104.4xd3.1) | NBR | |
| 26 | 143-041-12 | Pan Screw | 1 | M6x8 | SWRM | |
| 27 | 009-107-18 | Terminal | 2 | R-14-6 | CU | |
| 28 | 046-000-03 | Air Release Valve | 1 | PT-1/2 | SUS304 | |
| 29 | 217-000-18 | Fixing Plate | 1 | | FC | |
| 30 | 122-359-11 | O-Ring | 1 | 445xd5.7 | NBR | |
| 31 | 140-102-13 | Hex.Bolt | 6 | M12x55 | SUS304 | |
| 32 | 142-165-10 | Spring Washer | 6 | M12 | SUS304 | |
| 33 | 142-000-47 | Washer | 6 | M12(d12.5xd25.5x5t) | SUS304 | |
| 34 | 121-513-12 | Packing | 6 | d11.5xd21x4t | CR | |
| 35 | 122-353-15 | O-Ring | 1 | 310xd5.7 | NBR | |
| 36 | 072-103-23 | Eye Bolt | 2 | M24 | SUS304 | |
| 37 | 035-113-18 | Air Tightness Test Plug | 1 | M12x14 | SUS304 | |
| 38 | 121-247-12 | O-Ring | 1 | d12.3xd18x2t | PE | |
| 39 | 140-100-11 | Hex.Bolt | 6 | M12x45 | SUS304 | |
| 40 | 142-165-10 | Spring Washer | 6 | M12 | SUS304 | |
| 41 | 050-000-75 | Motor Bracket | 1 | | FC | |
| 42 | 122-353-15 | O-Ring | 1 | 310xd5.7 | NBR | |
| 43 | 142-000-73 | Wave Washer | 1 | 6310(d109xd92x7Hx1.2t) | SK5 | |
| 44 | 052-000-50 | Bearing | 1 | AC-6310ZZC3(MP-1) | | |

| PARTS LIST | | CONTRACTOR PUMP | | | 3/5/2013 | |
|------------|------------|----------------------------|------|---------------------|----------|-------|
| ITEM | PART No. | DESCRIPTION | QTY | SIZE | MATERIAL | NOTES |
| 45 | 016-000-04 | Lead Wire Protection Bush | 2 | d21xd52x11t | SBR | |
| 46 | 058-000-23 | Lead Wire Protection Plate | 1 | d120xd315x3t | SPCC | |
| 47 | 055-001-95 | Rotor | 1Set | | | |
| 48 | 147-000-38 | Impeller Key | 1 | 16x10x65L | SUS42J2 | |
| 49 | 053-001-67 | Motor Protector | 3 | YS11A135A-D20 | (H) | |
| 50 | 056-005-41 | Stator | 1Set | | | |
| 51 | 064-000-99 | Motor Frame | 1 | | FC | |
| 52 | 142-427-13 | Seal Washer | 2 | WD-12 | SPC+NBR | |
| 53 | 140-000-69 | Hex.Bolt | 2 | M12x25 | SS | |
| 54 | 140-128-15 | Hex.Bolt | 6 | M16x60 | SUS304 | |
| 55 | 142-166-11 | Spring Washer | 6 | M16 | SUS304 | |
| 56 | 122-308-15 | O-Ring | 1 | 320xd5.7 | NBR | |
| 57 | 140-055-78 | Hex.Bolt | 4 | M8x25 | SS | |
| 58 | 142-163-34 | Spring Washer | 4 | M8 | SWRH | |
| 59 | 133-001-19 | Bearing Upper Cover | 1 | WG1-4-37-BG/6-30-BG | FC | |
| 60 | 121-000-27 | Packing | 2 | 4x5.5x274 | Felt | |
| 61 | 052-000-55 | Bearing | 1Set | 7314BDB+KL10 | | |
| 62 | 142-247-17 | Bearing Washer | 1 | AW14 | SPCC | |
| 63 | 141-079-13 | Bearing Nut | 1 | AN14 | SS | |
| 64 | 122-149-16 | O-Ring | 1 | G-190(189.3xd5.7) | NBR | |
| 65 | 060-001-25 | Bearing Housing | 1 | | FC | |
| 66 | 122-265-19 | O-Ring | 1 | 335xd5.7 | NBR | |
| 67 | 148-002-16 | Grease Nipple | 1 | A-PT1/8 | C3604 | |
| 68 | 122-024-14 | O-Ring | 1 | P-25(24.7xd3.5) | NBR | |
| 69 | 144-000-47 | Grease Plug | 1 | M25x20 | SUS304 | |
| 70 | 090-112-18 | Leakage Sensor(Float) | 1 | OLV-5-2(B) | | |
| 71 | 142-293-18 | Seal Washer | 1 | W-10 | SUS304 | |
| 72 | 122-149-16 | O-Ring | 1 | G-190(189.3xd5.7) | NBR | |
| 73 | 113-000-04 | Grease Pan | 1 | CCKL21BG437/445/630 | FC | |
| 74 | 026-269-12 | Oil Seal | 1 | TC-60789 | NBR | |
| 75 | 140-269-19 | Hex.Socket Cap Bolt | 4 | M8x25 | SUS304 | |
| 76 | 065-000-47 | Outer Cover | 1 | | SGPSS | |
| 77 | 144-528-11 | U-bolt | 1 | C-#20-M10 | SUS304 | |
| 78 | 141-006-19 | Hex.Nut | 4 | M10 | SUS304 | |
| 79 | 122-359-11 | O-Ring | 1 | 445xd5.7 | NBR | |
| 80 | 026-269-12 | Oil Seal | 1 | TC-60789 | NBR | |
| 81 | 029-321-12 | Casing Cover | 1 | 200/250/300-22-6BG3 | FC | |
| 82 | 122-259-10 | O-Ring | 1 | 12xd3 | NBR | |
| 83 | 035-102-30 | Oil Plug | 1 | M12x16(B=21) | SUS304 | |
| 84 | 140-135-15 | Hex.Bolt | 4 | M16x100 | SUS304 | |
| 85 | 142-166-11 | Spring Washer | 4 | M16 | SUS304 | |
| 86 | 140-129-16 | Hex.Bolt | 4 | M16x65 | SUS304 | |
| 87 | 142-166-11 | Spring Washer | 4 | M16 | SUS304 | |
| 88 | 121-514-13 | O-Ring | 6 | d15.5xd27x4t | CR | |

| PARTS LIST | | CONTRACTOR PUMP | | | 3/5/2013 | |
|------------|------------|--------------------------|-----|-------------------------|----------|-------|
| ITEM | PART No. | DESCRIPTION | QTY | SIZE | MATERIAL | NOTES |
| 89 | 142-000-48 | Washer | 6 | M16(d16.5xd31.5x5t) | SUS304 | |
| 90 | 142-166-11 | Spring Washer | 6 | M16 | SUS304 | |
| 91 | 140-129-16 | Hex.Bolt | 6 | M16x65 | SUS304 | |
| 92 | 122-259-10 | O-Ring | 2 | 12xd3 | NBR | |
| 93 | 035-102-30 | Oil Plug | 2 | M12x16(B=21) | SUS304 | |
| 94 | 025-199-17 | Mechanical Seal | 1 | H-60 | SiC | |
| 95 | 143-028-13 | Pan Screw | 3 | M5x10 | SWRM | |
| 96 | 030-134-10 | Oil Lifter | 1 | H-60 | SPCC | |
| 97 | 122-266-10 | O-Ring | 1 | 460xd6 | NBR | |
| 98 | 122-265-19 | O-Ring | 1 | 335xd5.7 | NBR | |
| 99 | 122-259-10 | O-Ring | 1 | 12xd3 | NBR | |
| 100 | 035-102-30 | Drain Plug | 1 | M12x16(B=21) | SUS304 | |
| 101 | 029-317-28 | Oil Casing | 1 | 250-30-4BG3/150-37-4BG3 | FC | |
| 102 | 122-267-11 | O-Ring | 1 | 495xd5 | NBR | |
| 103 | 029-326-17 | Casing Plate | 1 | 200/250/300-22-6BG3 | FC | |
| 104 | 140-318-14 | Hex. Socket Cap Bolt | 3 | M16x45 | SUS304 | |
| 105 | 140-290-19 | Hex. Socket Cap Bolt | 3 | M10x45 | SUS304 | |
| 106 | 026-118-15 | Oil Seal | 1 | TC-709513 | NBR | |
| 107 | 071-000-05 | Shaft Sleeve | 1 | BK/BG(22-45KW) | SUS304 | |
| 108 | 034-426-14 | Mouth Ring(FC,Wear Ring) | 1 | d230xd282x25L(P.C.261) | FC | |
| 109 | 140-233-14 | Hex. Socket Cap Bolt | 4 | M5x12 | SUS304 | |
| 110 | 122-137-11 | O-Ring | 1 | G-130(129.4xd3.1) | NBR | |
| 111 | 026-267-10 | Labyrinth Ring | 1 | d110xd140x13L | SUS304 | |
| 112 | 026-268-11 | Oil Seal | 1 | TC-11014014 | NBR | |
| 113 | 021-000-64 | Impeller (60Hz) | 1 | (TO)200BK437-63 | FC | |
| 114 | 145-035-19 | Taper Pin | 1 | 5x10 | SUS304 | |
| 115 | 142-000-18 | Impeller Fixing Washer | 1 | M20,d55 | SUS304 | |
| 116 | 217-022-19 | Fixing Plate | 1 | d75x3 t M20(B=30) | SUS304 | |
| 117 | 140-232-13 | Hex. Socket Cap Bolt | 2 | M5x10 | SUS304 | |
| 118 | 140-148-11 | Hex.Bolt | 1 | M20x50 | SUS304 | |
| 119 | 020-951-10 | Pump Casing | 1 | 200B437-51/61 | FC | |
| 120 | 122-456-19 | O-Ring | 1 | 445xd5 | NBR | |
| 121 | 140-233-14 | Hex. Socket Cap Bolt | 4 | M5x12 | SUS304 | |
| 122 | 034-426-14 | Mouth Ring(FC) | 1 | d230xd282x25L(P.C.261) | FC | |
| 123 | 022-773-12 | Suction Cover | 1 | TO-150/200-37-4BG3 | FC | |
| 124 | 142-165-10 | Spring Washer | 8 | M12 | SUS304 | |
| 125 | 140-098-15 | Hex.Bolt | 8 | M12x35 | SUS304 | |
| 126 | 142-131-17 | Plain Washer | 4 | M20 | SUS304 | |
| 127 | 142-168-13 | Spring Washer | 4 | M20 | SUS304 | |
| 128 | 140-149-12 | Hex. Bolt | 4 | M20x55 | SUS304 | |
| 129 | 023-000-13 | Strainer Stand | 1 | BK(PC570) | FCD | |
| 130 | 121-166-29 | Packing | 1 | JIS5Kx200mm | NR | |
| 131 | 037-120-14 | Discharge Bend | 1 | 200x200mm | FC | |
| | 048-238-10 | Screwed Flange | 1 | JIS10Kx150mm | SS400 | |

| PARTS LIST | | CONTRACTOR PUMP | | | 3/5/2013 | |
|------------|------------|--|------|--------------------------|----------|-------|
| ITEM | PART No. | DESCRIPTION | QTY | SIZE | MATERIAL | NOTES |
| | 121-108-23 | Packing | 1 | JIS10Kx150mm | NR | |
| | 140-154-36 | Hex.Bolt | 8 | M20x80 | SWRM3 | |
| | 141-009-12 | Hex.Nut | 8 | M20 | SUS304 | |
| | 142-168-26 | Spring Washer | 8 | M20 | SWRH | |
| 132 | 142-166-11 | Spring Washer | 8 | M16 | SUS304 | |
| 133 | 140-128-15 | Hex.Bolt | 8 | M16x60 | SUS304 | |
| | | <TO Version> | | | | |
| | | <Packing O-Ring Set> | | | | |
| | 173-002-52 | Packing O-Ring Set | 1set | (Marked by *) | | |
| 25 | 122-132-16 | O-Ring (Stuffing Box) | 2 | G-105(104.4xd3.1) | NBR | |
| 30 | 122-359-11 | O-Ring (Fixing Plate Bolt/Outer Cover) | 1 | 445xd5.7 | NBR | |
| 34 | 121-513-12 | Packing (Fixing Plate Bolt) | 6 | d11.5xd21x4t | CR | |
| 35 | 122-353-15 | O-Ring (Fixing Plate/M.Bracket) | 1 | 310xd5.7 | NBR | |
| 38 | 121-247-12 | Packing (Air Tightness Test Plug) | 1 | d12.3xd18x2t | PE | |
| 42 | 122-353-15 | O-Ring (M.Bracket/M.Frame) | 1 | 310xd5.7 | NBR | |
| 56 | 122-308-15 | O-Ring (M.Frame/Brq.Housing) | 1 | 320xd5.7 | NBR | |
| 64 | 122-149-16 | O-Ring (Brq.Upp Cover/Brq.Housing) | 1 | G-190(189.3xd5.7) | NBR | |
| 66 | 122-265-19 | O-Ring (Brq.Housing/Casing Cover) | 1 | 335xd5.7 | NBR | |
| 68 | 122-024-14 | O-Ring (Grease Plug) | 1 | P-25(24.7xd3.5) | NBR | |
| 72 | 122-149-16 | O-Ring (Brq.Housing/Greese Pan) | 1 | G-190(189.3xd5.7) | NBR | |
| 79 | 122-359-11 | O-Ring (Out.Cover/Casing Cover) | 1 | 445xd5.7 | NBR | |
| 82 | 122-259-10 | O-Ring (Oil Plug) | 1 | 12xd3 | NBR | |
| 88 | 121-514-13 | Packing (Casing Cover Bolt) | 6 | d15.5xd27x4t | CR | |
| 92 | 122-259-10 | O-Ring (Oil Plug) | 2 | 12xd3 | NBR | |
| 97 | 122-266-10 | O-Ring (Casing Cover/P.Casing) | 1 | 460xd6 | NBR | |
| 98 | 122-265-19 | O-Ring (Casing Cover/P.Casing) | 1 | 335xd5.7 | NBR | |
| 99 | 122-259-10 | O-Ring (Drain Plug) | 1 | 12xd3 | NBR | |
| 102 | 122-267-11 | O-Ring (O.Casing/P.Casing) | 1 | 495xd5 | NBR | |
| 110 | 122-137-11 | O-Ring (Labyrinth Ring) | 1 | G-130(129.4xd3.1) | NBR | |
| 120 | 122-456-19 | O-Ring (P.Casing/S.Cover) | 1 | 445xd5 | NBR | |
| | | Lubricant | | Turbine Oil VG32 8,000ml | | |
| | | <Cooling Pipe Set> | | | | |
| | 080-000-89 | Cooling Pipe Set | 1Set | | SUS304 | |

EXPLODED VIEW

150BK437-53/63

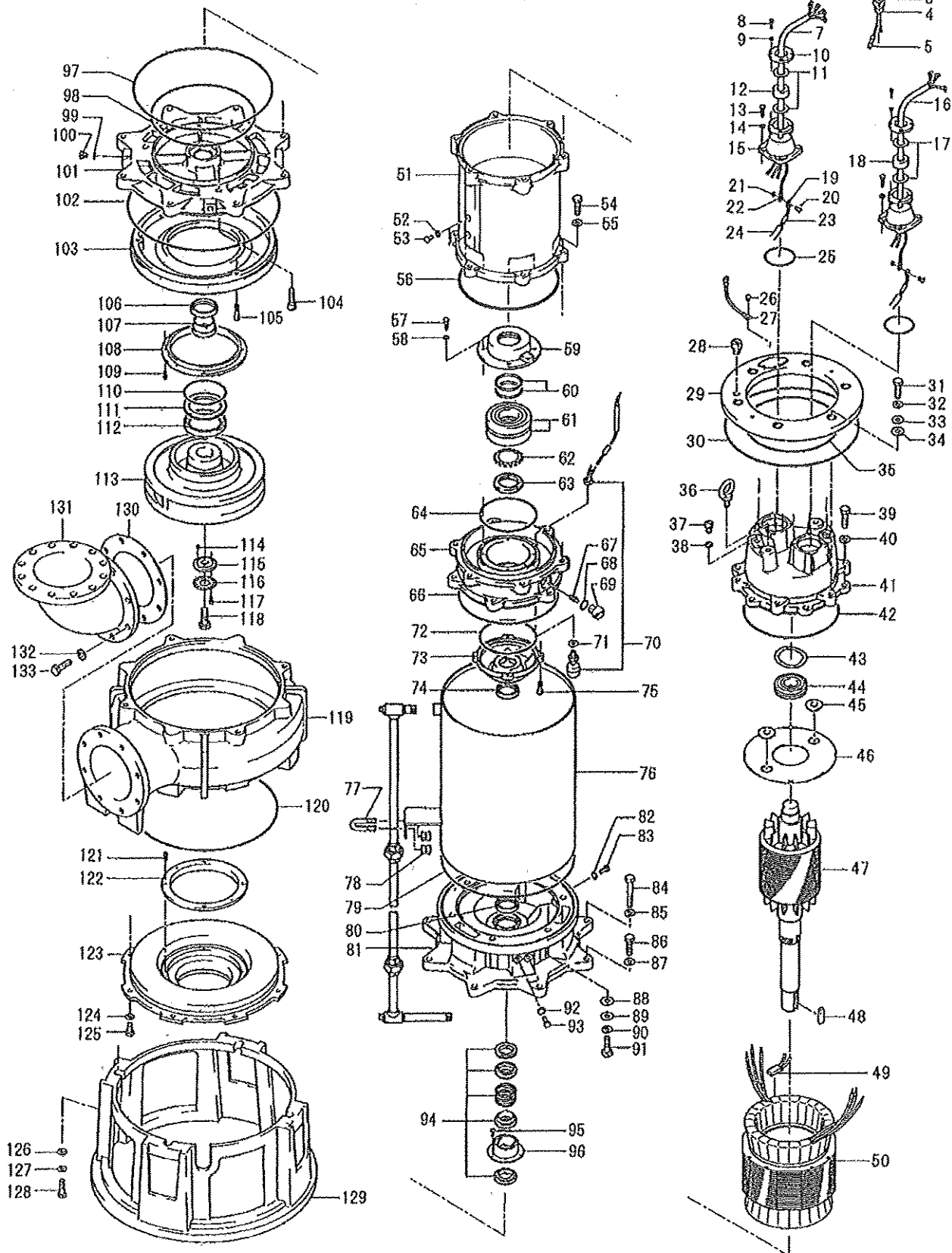

C-01209-1