

PARTS LIST		SEWAGE PUMP			9/5/2013	
ITEM	PART No.	DESCRIPTION	QTY	SIZE	MATERIAL	NOTES
1	009-127-14	Terminal	4	R-1.25-4	CU	
2	140-018-11	Hex Bolt	3	M5x15	SUS304	
3	142-422-18	Seal Washer	3	PM-5	SUS+NBR	
4	003-111-20	Gland	1		SUS304	
5	001-812-22	Cable	1	2PNCT4Cx1.25 完)	BE/CE型	
6	009-274-17	Terminal	4	TMNB-2		
7	009-117-11	Terminal	7	R-22-6	CU	
8	001-535-15	Cable	10	2PNCT4Cx22□	(円/m)	
9	140-056-11	Hex Bolt	8	M8x30	SUS304	
10	141-005-18	Hex Nut	8	M8	SUS304	
11	003-188-15	Gland	2	BG3型(30-4P)	FC	
12	005-139-17	Bushing Washer	2	φ33xφ53.5x3t	SUS304	
13	004-111-23	Cable Bushing	1	工事 No.6A	SBR	
14	140-076-17	Hex Bolt	8	M10x30	SUS304	
15	142-164-19	Spring Washer	8	M10	SUS304	
16	006-162-12	Stuffing Box	2	BG3型	FC	
17	009-117-11	Terminal	6	R-22-6	CU	
18	140-029-31	Hex Bolt	7	M6x10	C3604	
19	002-115-18	Shrink Tubing	m	内装EVAチューブ (φ16.5x1t)	(円/m)	
20	141-004-46	Hex Nut	7	M6	C3604	
21	009-117-11	Terminal	7	R-22-6	CU	
22	002-116-19	Shrink Tubing	m	外装スチューブ A4(φ20x0.35t)	(円/m)	
23	122-132-16	O-Ring	2	G-105(104.4xφ3.1)	NBR	
24	001-533-13	Cable	10	2PNCT3Cx22□	(円/m)	
25	005-138-16	Bushing Washer	2	φ29xφ53.5x3t	SUS304	
26	004-110-19	Cable Bushing	1	設備 No.6	SBR	
27	046-000-03	Air Valve	1	PT-1/2(リングナット20L)	SUS304	
28	217-000-04	Pressing Plate	1	φ310xφ478x28t	FC	
29	122-359-11	O-Ring	1	445xφ5.7	NBR	
30	140-129-16	Hex Bolt	6	M16x65	SUS304	
31	142-166-11	Spring Washer	6	M16	SUS304	
32	142-000-48	Washer	6	M16(φ16.5xφ31.5x5t)	SUS304	
33	121-514-13	Seal Packing	6	φ15.5xφ27x4t	CR	
34	122-161-14	O-Ring	1	G-300(299.3xφ5.7)	NBR	
35	143-041-12	Pan Head Screw	1	M6x8	SWRM	
36	009-107-18	Terminal	2	R-14-6	CU	
37	072-108-28	Hanging Bolt	2	M30 吊ボルト	SUS304	
38	142-453-18	Washer		M30(φ31xφ59 x 0.1t)	SUS304	
	142-454-19	Washer		M30(φ31xφ59 x 0.3t)	SUS304	
39	035-102-30	Air Tight Plug	1	M12x16(B=21)	SUS304	
40	122-259-10	O-Ring	1	12xφ3	NBR	
41	140-126-13	Hex Bolt	6	M16x50	SUS304	
42	142-166-11	Spring Washer	6	M16	SUS304	
43	050-501-14	Motor Bracket	1		FC	

PARTS LIST		SEWAGE PUMP			9/5/2013	
ITEM	PART No.	DESCRIPTION	QTY	SIZE	MATERIAL	NOTES
44	122-108-13	O-Ring	1	P-320(318.5xφ8.5)	NBR	
45	142-452-17	Waveform Block Gold	1	#6310用(φ108x5t)	SK5	
46	122-133-17	O-Ring	1	G-110(109.4xφ3.1)	NBR	
47	052-113-11	Bearing	1	6310Z3C3		
48	058-000-06	Lead Wire Protection Plate	1	φ136xφ324x3.2t	SPHC	
50	147-173-16	Shaft	1	16x10x65L(両角)	SUS304	
51	053-001-56	Protector	3	F-11	(H)	
		<Old Parts>				
49	055-897-15	Rotor	1組			
52	056C8315	Stator	1式			
		<New Parts>				
49	055-001-58	Rotor	1組			
52	056-004-77	Stator	1式			
53	140-128-15	Hex Bolt	6	M16x60	SUS304	
54	142-166-11	Spring Washer	6	M16	SUS304	
55	064-578-15		1		FC	
56	142-297-12	Seal Washer	2	SM-10	SUS+NBR	
57	140-000-08	Hex Bolt	2	M10x18	SUS304	
58	122-108-13	O-Ring	1	P-320(318.5xφ8.5)	NBR	
59	140-055-49	Hex Bolt	4	M8x25	SWRM	
60	142-163-34	Spring Washer	4	M8	SWRH	
61	133-001-19	Bearing Cover	1	WG1-4-37-BG/6-30-BG	FC	
62	121-000-27	Packing	2	4x5.5x274	フエルト	
63	052-225-17	Bearing	1組	7314BT1DB+10D3C3.NTN		
64	142-247-17	Bearing Washer	1	AW14	SPCC	
65	141-079-13	Bearing Nut	1	AN14	SS	
66	122-149-16	O-Ring	1	G-190(189.3xφ5.7)	NBR	
67	060-495-15	Bearing Housing	1		FC	
68	122-265-19	O-Ring	1	335xφ5.7	NBR	
69	009-105-16	Terminal	2	2口		
70	148-002-16	Grease Nipple	1	A-PT1/8	C3604	
71	122-023-13	O-Ring	1	P-24(23.7Xφ3.5)	NBR	
72	204-047-10	Plug	1	M24x20(ガラスチップ 保護用)	SUS304	
73	090-112-18	Leak Sensor	1	OLV-5-2(B接点仕様)		
74	142-293-18	Seal Washer	1	W-10	SUS304	
75	122-149-16	O-Ring	1	G-190(189.3xφ5.7)	NBR	
76	113-105-12	Bearing Grease Cup	1	WG1-4-37-BG/6-30-BG	FC	
77	026-269-12	Oil Seal	1	TC-60789	NBR	
78	140-269-19	Socket Head Cap Screw	4	M8x25	SUS304	
79	065-000-06	Out Cover	1		SGPSS	
80	144-528-11	U-Bolt	1	C-#20-M10	SUS304	
81	141-006-19	Hex Nut	4	M10	SUS304	
82	122-359-11	O-Ring	1	445xφ5.7	NBR	
83	026-269-12	Oil Seal	1	TC-60789	NBR	

PARTS LIST		SEWAGE PUMP			9/5/2013	
ITEM	PART No.	DESCRIPTION	QTY	SIZE	MATERIAL	NOTES
84	029-321-12	Casing Cover	1	200/250/300-22-6BG3用	FC	
85	122-259-10	O-Ring	1	12xφ3	NBR	
86	035-102-30	Drain Plug	1	M12x16(B=21)	SUS304	
87	140-135-15	Hex Bolt	4	M16x100	SUS304	
88	142-166-11	Spring Washer	4	M16	SUS304	
89	140-129-16	Hex Bolt	4	M16x65	SUS304	
90	142-166-11	Spring Washer	4	M16	SUS304	
91	121-514-13	Seal Packing	6	φ15.5xφ27x4t	CR	
92	142-000-48	Washer	6	M16(φ16.5xφ31.5x5t)	SUS304	
93	142-166-11	Spring Washer	6	M16	SUS304	
94	140-129-16	Hex Bolt	6	M16x65	SUS304	
95	122-259-10	O-Ring	2	12xφ3	NBR	
96	035-102-30	Oil Plug	2	M12x16(B=21)	SUS304	
97	025-000-51	Mechanical Seal	1	H-60型	SIC	
98	143-028-13	Pan Head Screw	3	M5x10	SWRM	
99	030-134-10	Oil Lifter	1	H-60用	SPCC	
100	122-266-10	O-Ring	1	460xφ6	NBR	
101	122-265-19	O-Ring	1	335xφ5.7	NBR	
102	122-259-10	O-Ring	1	12xφ3	NBR	
103	035-102-30	Oil Drain Plug	1	M12x16(B=21)	SUS304	
104	029-317-28	Oil Casing	1	250-30-4BG3/150-37-4BG3用	FC	
105	122-267-11	O-Ring	1	495xφ5	NBR	
106	029-326-17	Casing Plate	1	200/250/300-22-6BG3用	FC	
107	140-318-14	Socket Head Cap Screw	3	M16x45	SUS304	
108	140-290-19	Socket Head Cap Screw	3	M10x45	SUS304	
109	026-118-15	Oil Seal	1	TC-709513	NBR	
110	071-000-05	Shaft Sleeve	1	BK/BG(22-45KW)用	SUS304	
111	034-426-14	Wear Ring	1	φ230xφ282x25L(P.C.261)	FC	
112	140-233-14	Socket Head Cap Screw	4	M5x12	SUS304	
113	122-137-11	O-Ring	1	G-130(129.4xφ3.1)	NBR	
114	026-267-10	Labyrinth Ring	1	φ110xφ140x13L	SUS304	
115	026-268-11	Oil Seal	1	TC-11014014	NBR	
116	021-000-63	Impeller (50Hz)	1	(TO)200BK437-51用	FC	
116	021-000-64	Impeller (60Hz)	1	(TO)200BK437-61用	FC	
117	145-035-19	Parallel Pin	1	φ5x10L	SUS304	
118	142-000-18	Impeller Fixing Washer	1	M20, 2+7 t φ55用	SUS304	
119	217-022-19	Fixing Plate	1	φ75x3 t M20用(B=30)	SUS304	
120	140-232-13	Socket Head Cap Screw	2	M5x10	SUS304	
121	140-148-11	Hex Bolt	1	M20x50	SUS304	
122	020-951-10	Pump Casing	1	200B437-52/62用	FC	
123	122-456-19	O-Ring	1	445xφ5	NBR	
124	140-233-14	Socket Head Cap Screw	4	M5x12	SUS304	
125	034-426-14	Wear Ring	1	φ230xφ282x25L(P.C.261)	FC	
126	022-773-12	Suction Cover	1	TO-150/200-37-4BG3用	FC	

PARTS LIST		SEWAGE PUMP			9/5/2013	
ITEM	PART No.	DESCRIPTION	QTY	SIZE	MATERIAL	NOTES
127	142-165-10	Spring Washer	8	M12	SUS304	
128	140-098-15	Hex Bolt	8	M12x35	SUS304	
129	142-131-17	Plain Washer	4	M20	SUS304	
130	142-168-13	Spring Washer	4	M20	SUS304	
131	140-149-12	Hex Bolt	4	M20x55	SUS304	
132	023-000-13	Strainer Stand	1	BK型(PC570)用	FCD	
133	121-166-29	Packing	1	JIS5Kx200mm	NR	
134	037-120-14	Discharge Bend	1	200x200mm	FC	
135	142-166-11	Spring Washer	8	M16	SUS304	
136	140-127-14	Hex Bolt	8	M16x55	SUS304	
		<Detachable Specification>				
	099-114-17	Companion Flange	1	TO-200(高压用)	FC	
	121-166-29	Packing	1	JIS5Kx200mm	NR	
	140-318-14	Socket Head Cap Screw	8	M16x45	SUS304	
	093-000-03	Guide Hook	1	TO-200/250型(高压用)	FCD	
	140-154-10	Hex Bolt	3	M20x80	SUS304	
	142-168-13	Spring Washer	3	M20	SUS304	
	091-108-14	Removable Bend	1	TO-200型(JIS10K)	FC	
	094-109-14	Guide Support	1	TO-150/250	FCD	
	140-099-16	Hex Bolt	3	M12x40	SUS304	
	141-007-49	Hex Nut	3	M12(3種)	SUS304	
	142-129-12	Plain Washer	3	M12	SUS304	
	096-103-14	Guide Connector	2	40mm	SS	
	140-101-12	Hex Bolt	2	M12x50	SUS304	
	142-165-10	Spring Washer	2	M12	SUS304	
	173-001-69	O-Ring Set	1式	(*印)		
23	122-132-16	Stuffing Box O-Ring	2	G-105(104.4xφ3.1)	NBR	
29	122-359-11	Fixing plate/ outer cover O-Ring	1	445xφ5.7	NBR	
33	121-514-13	Retainer Plate mounting bolts seal packing	6	φ15.5xφ27x4t	CR	
34	122-161-14	Fixing Plate/Motor Bracket O-Ring	1	G-300(299.3xφ5.7)	NBR	
40	122-259-10	Airtight Plug O-Ring	1	12xφ3	NBR	
44	122-108-13	Motor Bracket/Motor Frame O-Ring	1	P-320(318.5xφ8.5)	NBR	
46	122-133-17	Upper Bearing O-Ring	1	G-110(109.4xφ3.1)	NBR	
56	142-297-12	Stator Set Bolt Seal Washer	2	SM-10	SUS+NBR	
58	122-108-13	Motor Frame/Bearing Housing O-Ring	1	P-320(318.5xφ8.5)	NBR	
66	122-149-16	Bearing Cover/Bearing Housing O-Ring	1	G-190(189.3xφ5.7)	NBR	
68	122-265-19	Bearing Housing/Casing Cover O-Ring	1	335xφ5.7	NBR	
71	122-023-13	Protective Plug O-Ring	1	P-24(23.7Xφ3.5)	NBR	
75	122-149-16	O-Ring received Bearing Housing/grease	1	G-190(189.3xφ5.7)	NBR	
82	122-359-11	Outer Cover/Casing Cover O-Ring	1	445xφ5.7	NBR	
85	122-259-10	Drain Plug O-Ring	1	12xφ3	NBR	
91	121-514-13	Casing Cover mounting Bolt seal Packing	6	φ15.5xφ27x4t	CR	
95	122-259-10	Oil Plug O-Ring	2	12xφ3	NBR	
100	122-266-10	Casing Cover/Oil Casing O-Ring	1	460xφ6	NBR	

PARTS LIST		SEWAGE PUMP				9/5/2013
ITEM	PART No.	DESCRIPTION	QTY	SIZE	MATERIAL	NOTES
101	122-265-19	Casing Cover/Oil Casing O-Ring	1	335xφ5.7	NBR	
102	122-259-10	Oil Drain Plug O-Ring	1	12xφ3	NBR	
105	122-267-11	Oil Casin/ Pump casing O-Ring	1	495xφ5	NBR	
113	122-137-11	Labyrinth Ring O-Ring	1	G-130(129.4xφ3.1)	NBR	
123	122-456-19	Pump Casing/Suction Cover O-Ring	1	445xφ5	NBR	
		Mechanical Seal Lubrication Oil		カーボン油VG32 8,000ml		
		<Chain Shackle> SS				
	095-149-19	straight chain	1	11mmx5M(リンク付)	SS	
	011-105-13	shackle	1	16mm(ナミ秒)	SS	
	095-250-14	hanging chain (2 points)	1	11mm(11L)	SS	
	011-105-13	shackle	2	16mm(ナミ秒)	SS	
		<Chain Shackle> SUS				
	095-150-13	straight chain	1	11mmx5M	SUS304	
	011-137-14	shackle	1	16mm(ナミ秒)	SUS304	
	095-108-29	hanging chain (2 points)	1	11mm(8L)	SUS304	
	011-137-14	shackle	2	16mm(ナミ秒)	SUS304	
		<Cooling Pipe>				
	080-000-89	Cooling Pipe	1式		SUS304	
		<Impeller Removal Tool				
	183-005-18	Impeller Removal Tool	1	B型 No.5	FCD	

PARTS LIST		SEWAGE PUMP			9/5/2013	
ITEM	PART No.	DESCRIPTION	QTY	SIZE	MATERIAL	NOTES

分解組立

200BK437-51/61/52/62

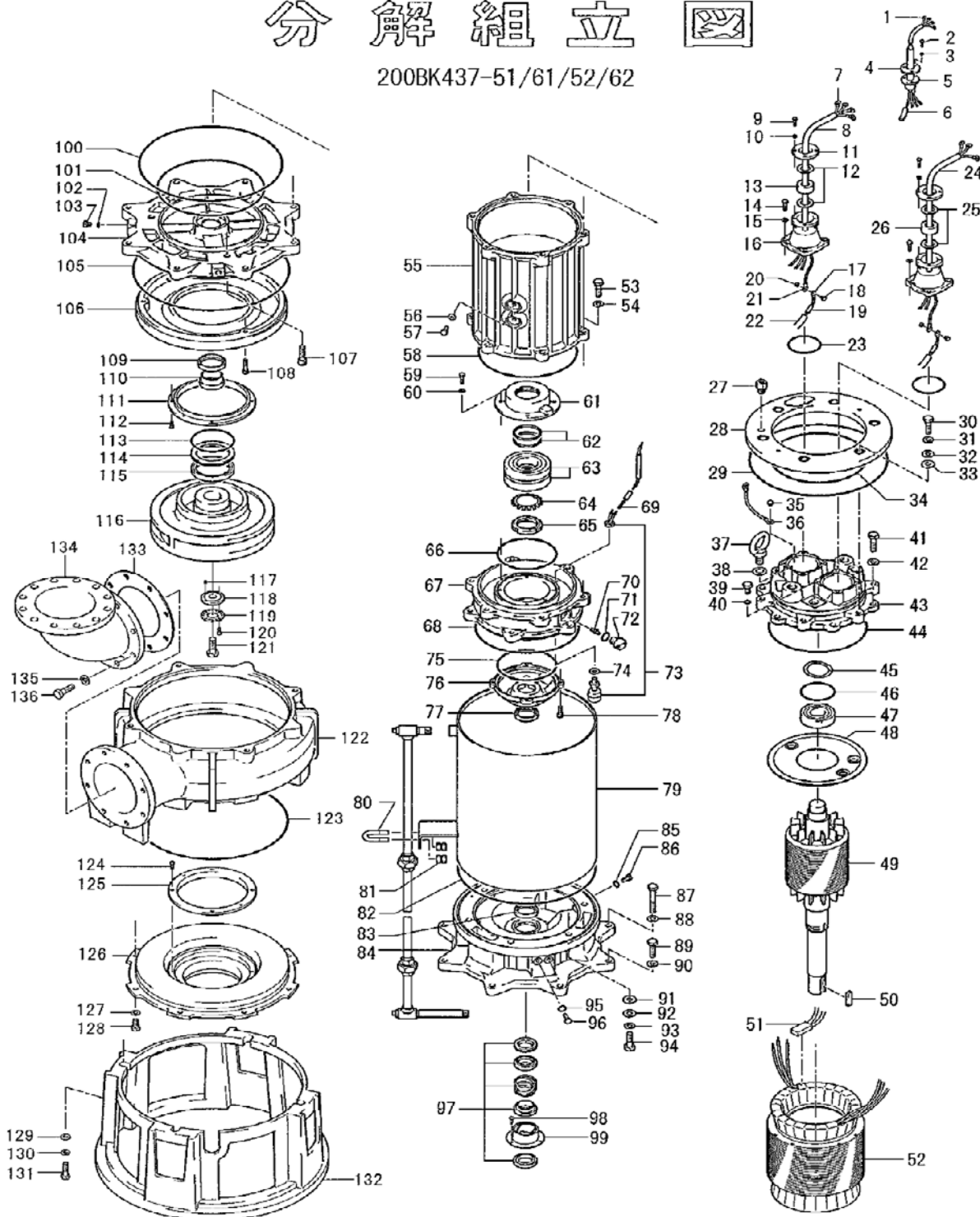

管理no. C-01076-1